

FREQUENTLY ASKED QUESTIONS

WHAT ARE THE PROJECTED DIRECT COSTS FOR THE ENTIRE CAMPUS PROJECT?

The total cost of construction is about \$1.9 million. Architectural, engineering and consulting fees, technology, furnishings and interest during construction are projected to bring direct costs to about \$2.3 million.

HOW WILL THE CAMPUS PROJECT BE FINANCED?

The synod has made application to the Mission Investment Fund of the ELCA for a loan to cover all direct costs.

WHAT ARE THE PLANS TO REPAY THE LOAN?

The financial goal of **Making Us One** is to receive \$2 million by December 31, 2014, the end of the five-year pledge period. In addition, the synod is budgeting \$51,000 per year from its operations budget to pay down the mortgage. The combination of \$2 million and payments from operations is intended to eliminate the mortgage in five years.

HOW DOES THE SYNOD PLAN TO RAISE \$2 MILLION IN CHALLENGING FINANCIAL TIMES?

The **To Whom Shall We Go** capital fund appeal generated about \$500,000 for this building project. The availability of these funds has allowed the synod to pay nearly \$300,000 to date towards project costs. The plan for **Making Us One** is to encourage 100% participation from the synod's 129 congregations, the Synod Council, and its 235 rostered leaders. In addition, **Making Us One** will seek commitments from individuals and congregations who wish to support the vision of collaboration in mission and ministry being developed and implemented by the Center for Mission & Ministry.

HOW WILL CONGREGATIONS AND INDIVIDUALS BE ASKED TO PLEDGE?

The method of **Making Us One** is to raise \$2 million-one gift at a time! We are inviting donors to consider this example as a basic five-year gift:

- Year One: \$20/month or \$240/year
- Year Two: \$25/month or \$300/year
- Year Three: \$30/month or \$360/year
- Year Four: \$35/month or \$420/year
- Year Five: \$40/month or \$480/year

Over a five-year period, this means a total commitment of \$1800. We believe that this approach will allow every congregation and many individuals to make a pledge in uncertain financial times.

DOESN'T IT TAKE LOTS OF PLEDGES TO RAISE \$2 MILLION?

It takes one thousand one hundred and eleven! We believe that receiving 1111 gift units of \$1800 is possible and that this approach will serve as a positive reminder that this project is truly owned by the people of the synod. At the same time, larger gifts from individuals and congregations (especially early on) will be necessary to meet the goal to be debt free in five years.

DO YOU HAVE ANY SUGGESTED GUIDELINES FOR CONGREGATIONAL PARTICIPATION IN MAKING US ONE?

If every congregation gives one gift unit of \$1800 per year for five years, more than 50% of the goal will be reached! The remainder of the goal can be reached by a combination of additional gifts from congregations and gifts from individuals. Some congregations are making pledges as part of their budgets; others are challenging individuals and groups within their congregations to step forward on their behalf.

WHAT IS THE PLAN FOR RECEIVING PLEDGES AND CONTRIBUTIONS?

The formal launch of **Making Us One** coincided with the groundbreaking on April 19. The initial in-gathering of pledges from rostered and lay leaders and congregations occurred at the 2009 Synod Assembly. Pledges will be requested and accepted throughout the five-year period.

WHEN SHOULD DONORS BEGIN PAYING ON PLEDGES?

Payments have been accepted since June 2009. Donors will be contacted individually to confirm starting dates for payment. All monies received before construction begins will be placed into an interest-bearing account with MIF.

A VISION FOR COLLABORATION IN MISSION & MINISTRY

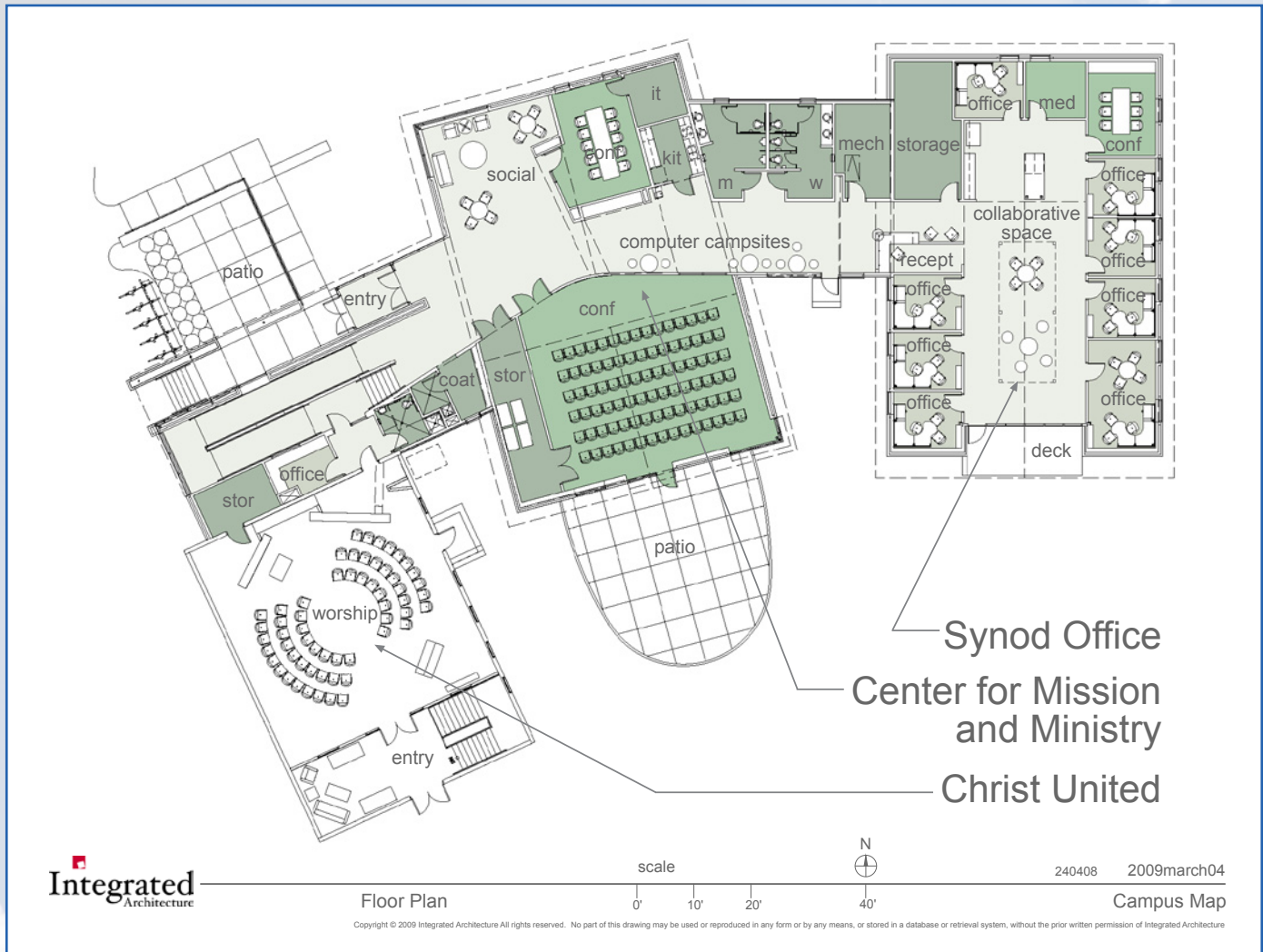

The purpose of the Center for Mission & Ministry is to be a catalyst for growth and renewal, connection and collaboration. Its ministry is informed by five vision elements:

It is part of a campus

one of three inter-connected buildings and three inter-related communities.

It is distinctive

a Lutheran presence devoted to ecumenical and interfaith partnerships.

It is focused

on building community, discerning vocations, and promoting earthkeeping.

It is equipped

with appropriate technology and effective, flexible gathering spaces.

It is a grass-roots movement

of, by, and for pastors on behalf of their congregations.

Making Us One